



# C0066 Saugus Phase I Bouquet Canyon Trail to Central Park

November 09, 2022



# Project Limits

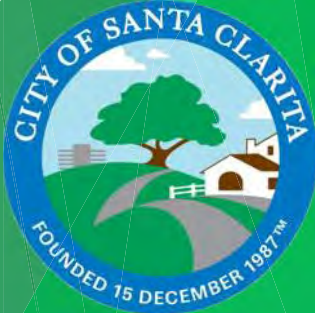

# Project Limits

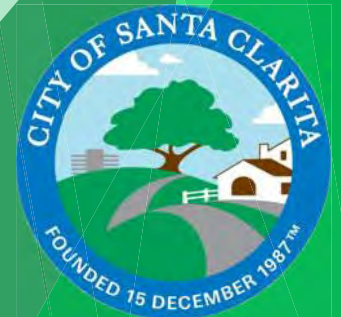

# Non-Motorized Transportation Plan

---

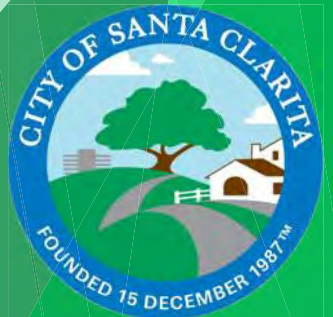
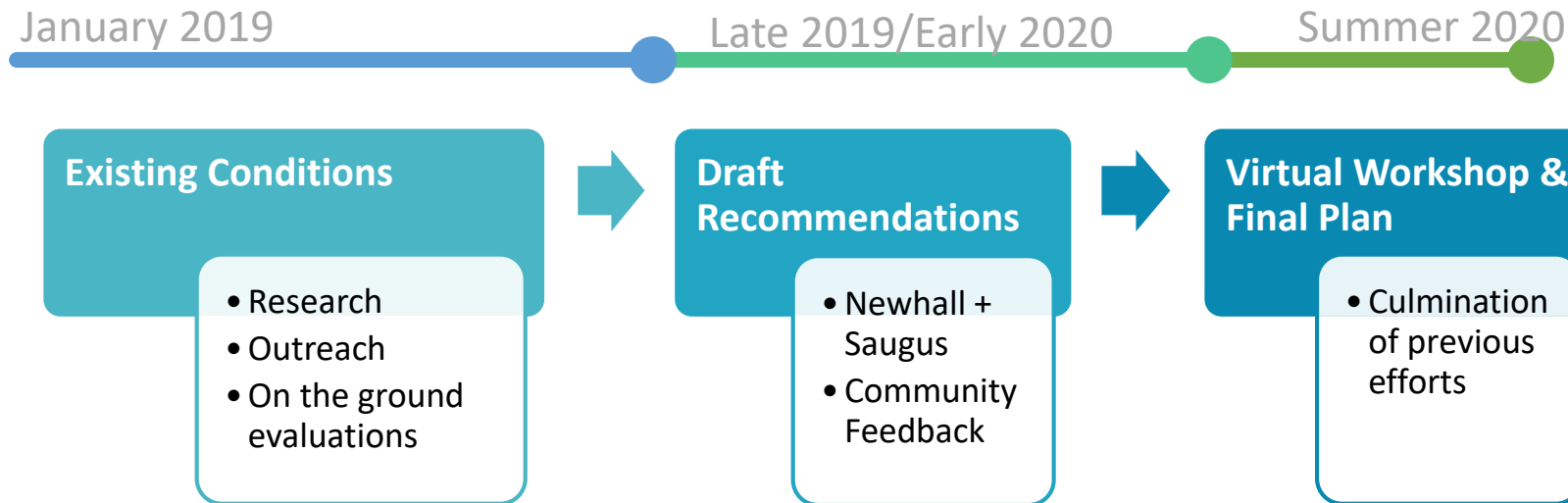

# Community Collaboration

- ▶ Plan represents feedback from over 800 residents
  - Community Meetings
  - Community Survey
  - Public Input Map
  - Pop-Up Events
  - Presentation to the Parks, Recreation, and Community Services Commission
  - Stakeholder Workshop

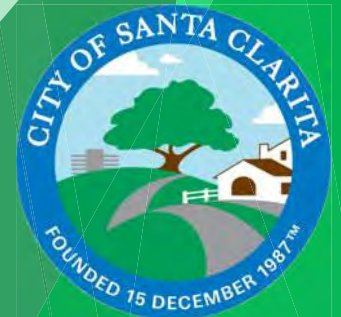
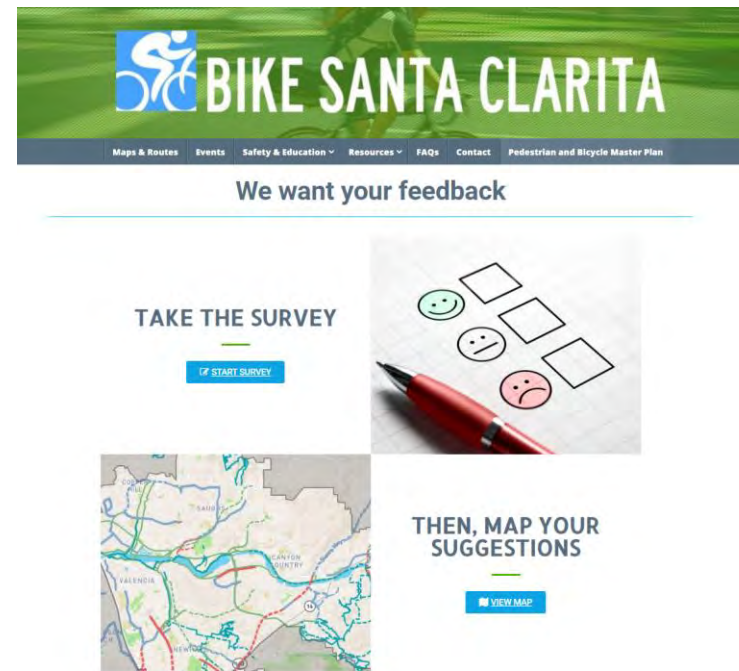

# Public Input Map

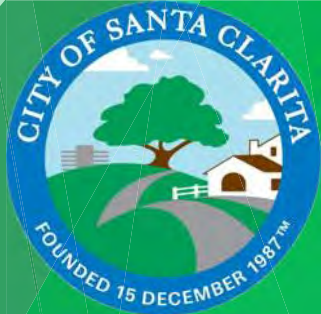
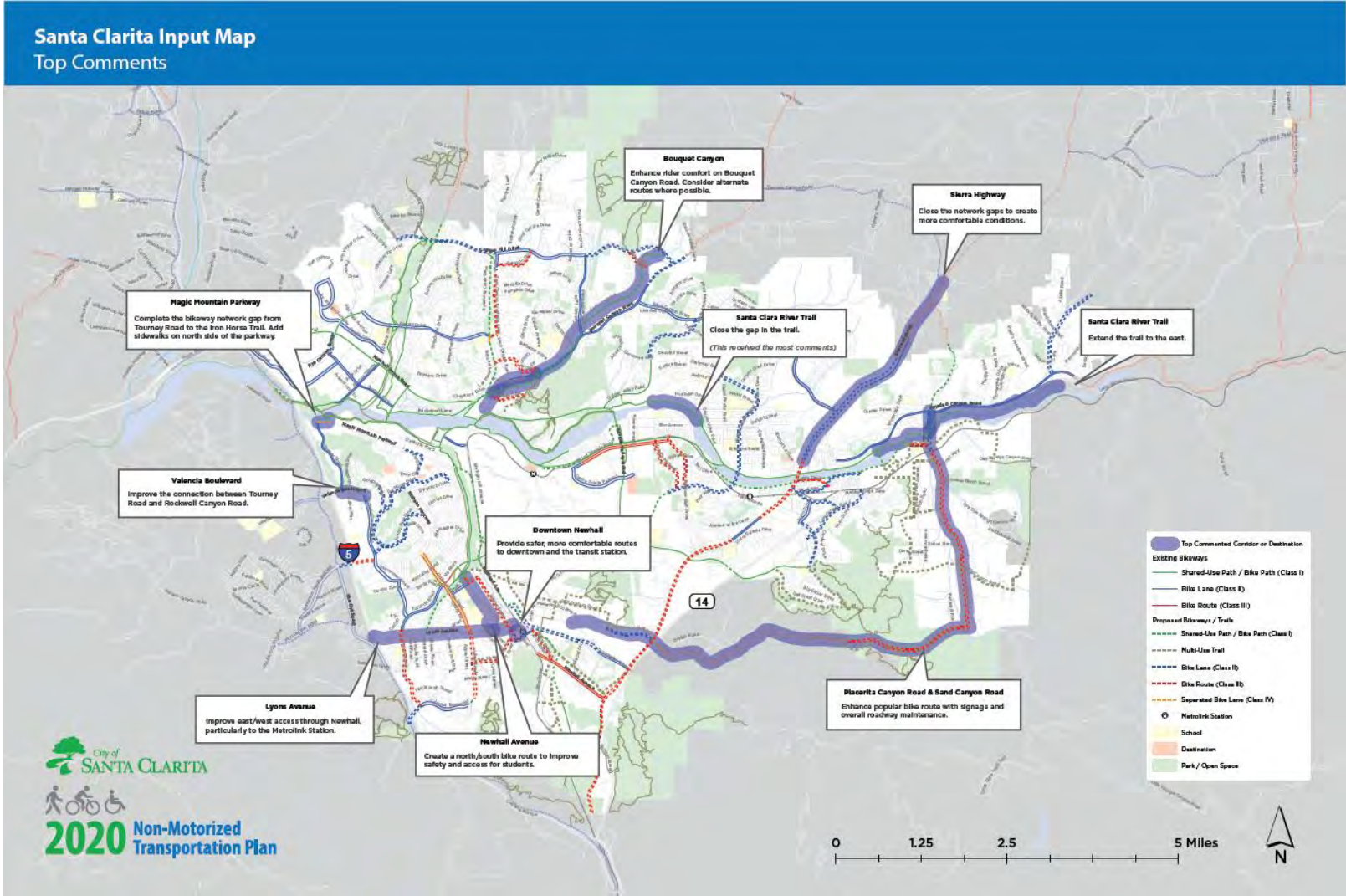

# Public Input Map

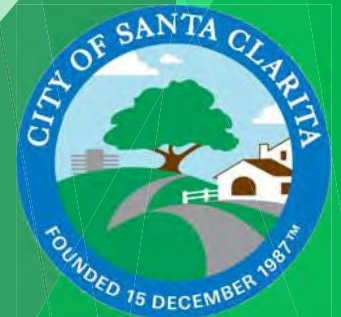
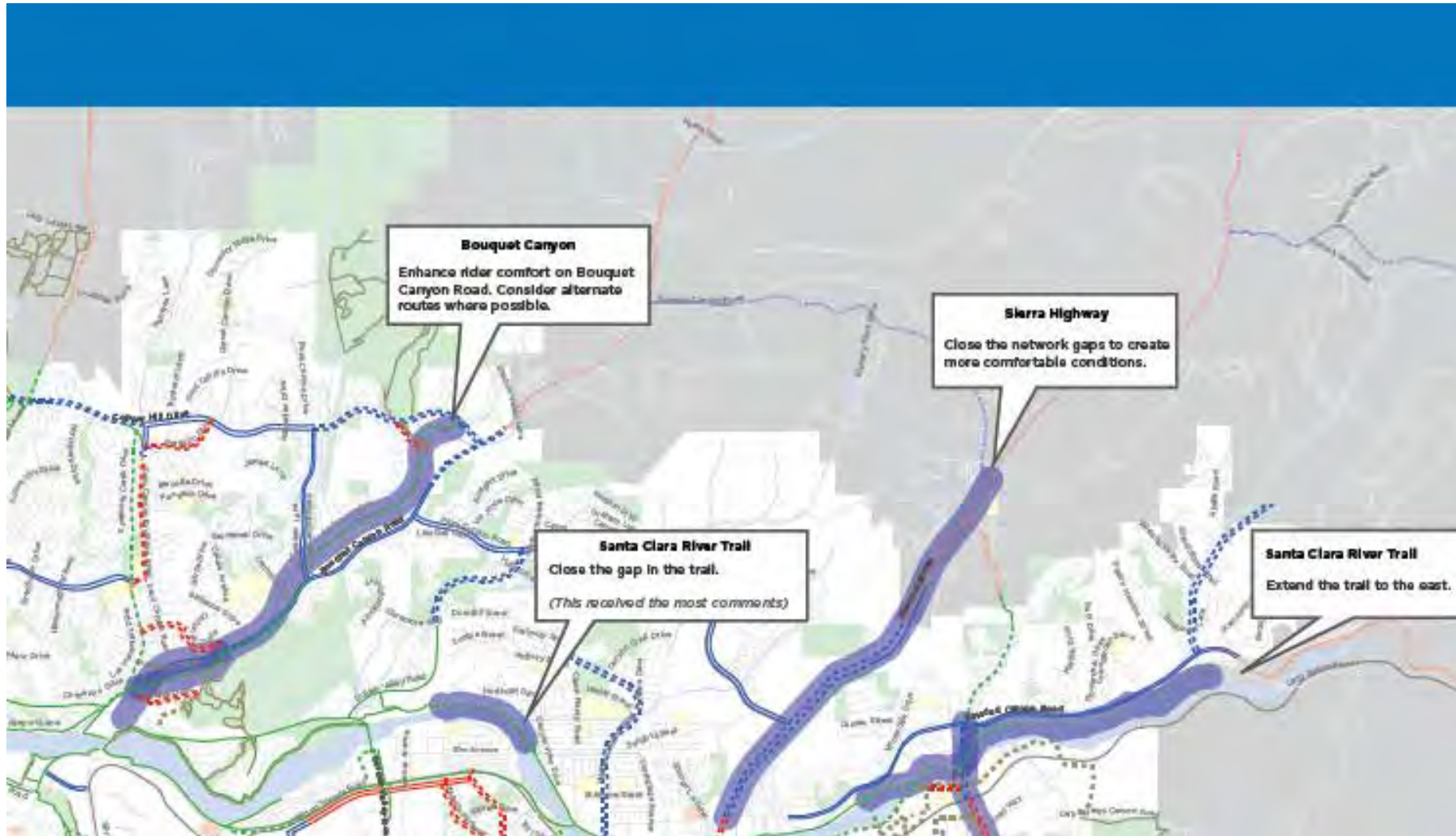

# Hit the Trail 2021 Pop-Up Route

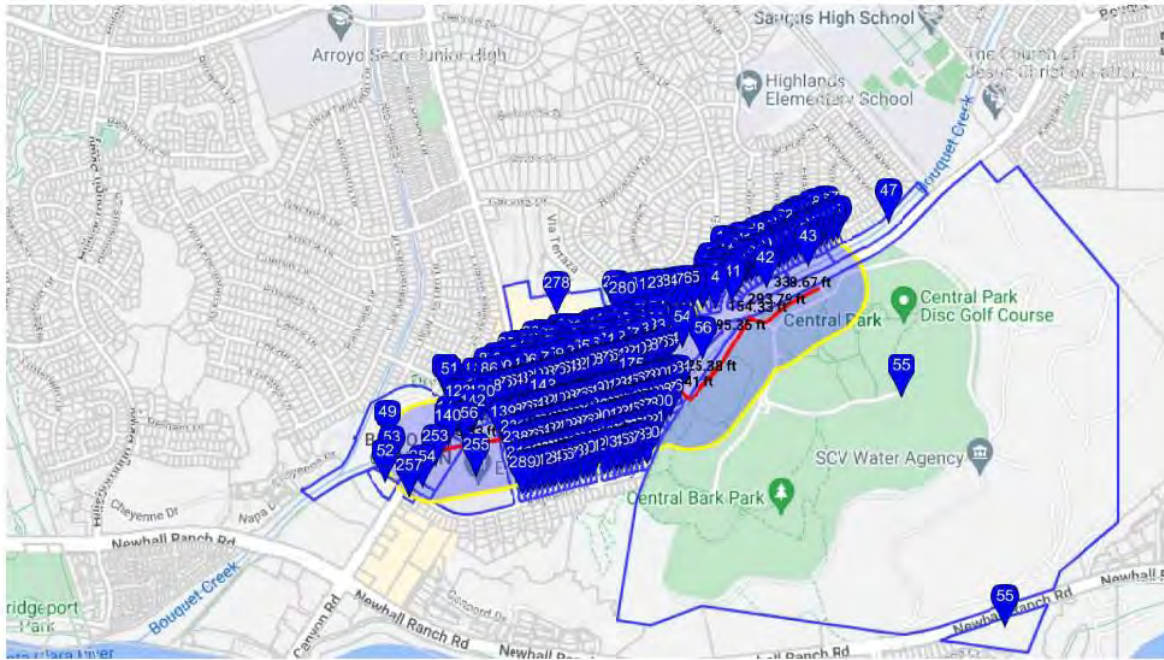

Join us for **Hit the Trail 2021**, featuring a Pop-up Trail event along lower Bouquet Creek! Bring the whole family together and explore the City of Santa Clarita's bike trail system on the Hit the Trail Community Bike Ride on Saturday, May 15, from 10:00 a.m. to 2:00 p.m. The free event features a self-guided, non-competitive bike ride for individuals and families throughout Santa Clarita and no registration is required to participate. Come and try out your **car-free connection** to the City's 43-mile network of bicycle and pedestrian trails.



Hit the Trail and the Pop-Up Trail will be hosted by the City of Santa Clarita. For any questions about the event, please contact Trails and Bikeway Planning Administrator Tom Reilly at [treilly@santa-clarita.com](mailto:treilly@santa-clarita.com) or call (661) 255-4394.

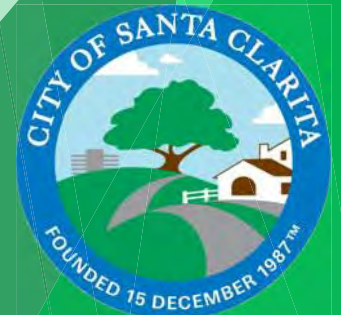



# Hit the Trail 2021 Pop-Up Route

## ► Event Day Recap

- Trail was open from 10:00 a.m. until 2:00 p.m.
- Route was striped and temporary barriers installed.
- 43 users enjoyed the demonstration, including two adjacent residents.

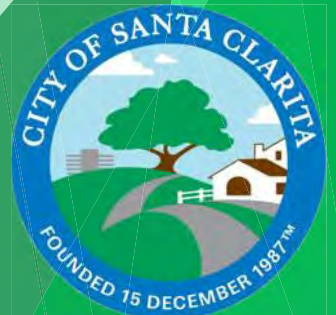

# Measure M Funding

---

- ▶ Los Angeles County voters approved Measure M in 2016.
- ▶ Half-cent sales tax measure to fund projects which ease traffic.
- ▶ Jurisdiction receive funding specific to three categories:
  - Active Transportation
  - Transit
  - Highway Efficiency Program

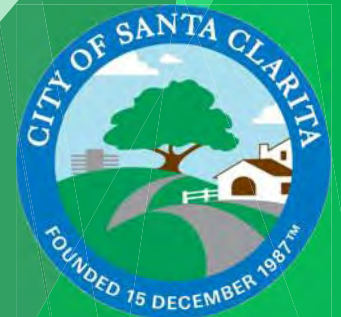

# August 2022 Community Input

August 2022 Survey Responses

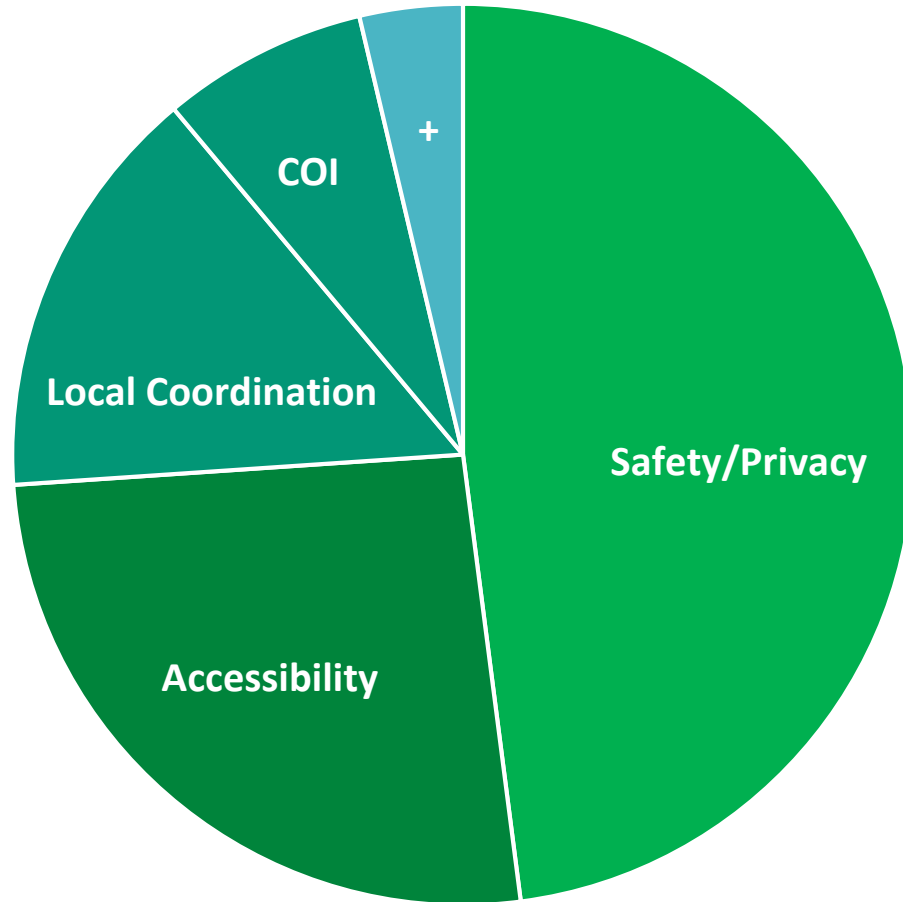

■ Safety/Privacy ■ Accessibility ■ Local Coordination ■ Conflict of Interest ■ Positive Feedback

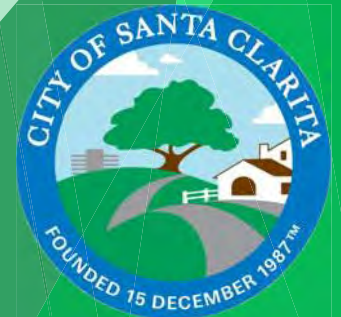

# Similar Configurations & Safety

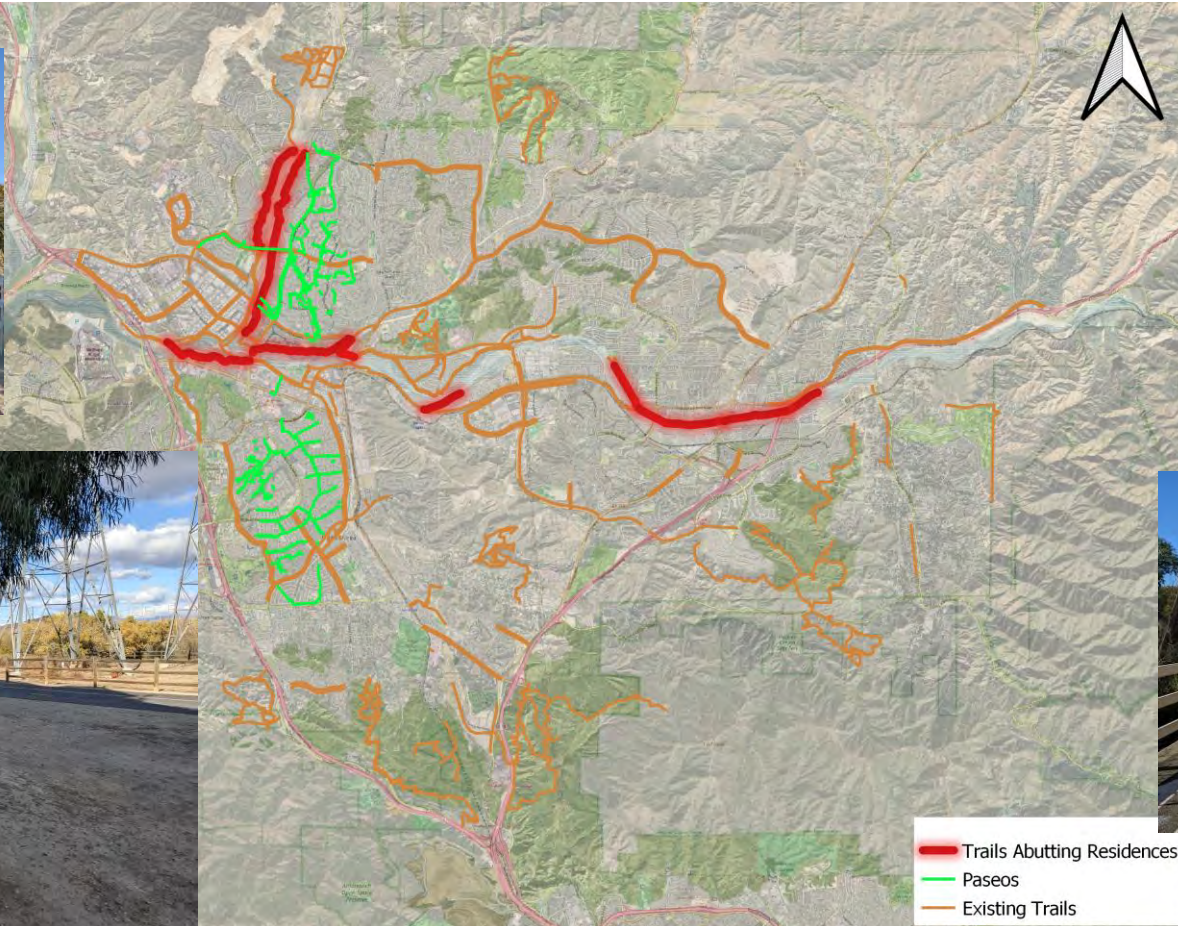

▶ 10.4 miles Class I

▶ 29 Miles of Paseos

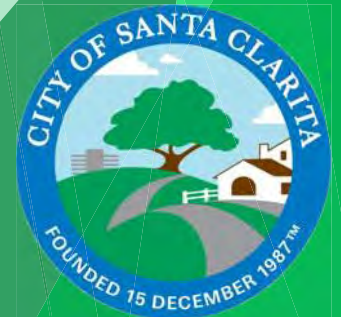

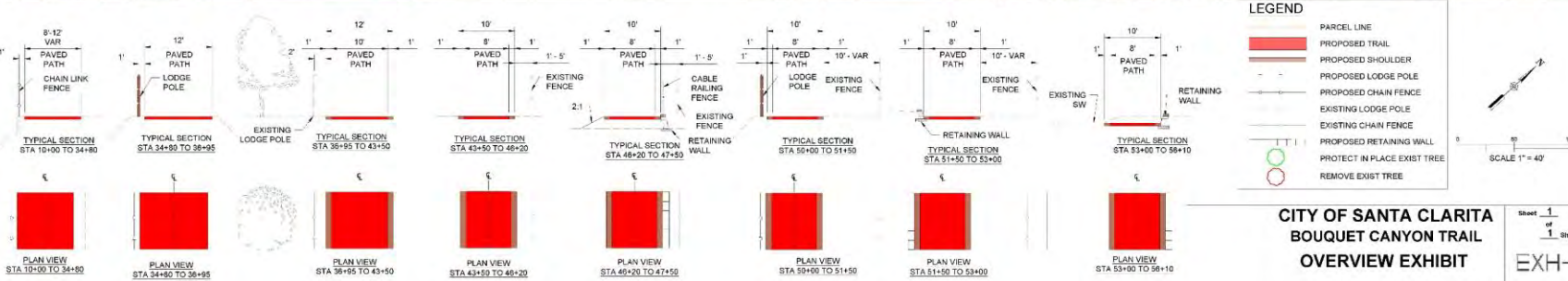

# Proposed Design



# Proposed Design



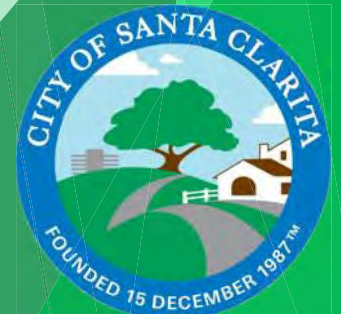

Privacy Fencing Cover Treatment Options Along Bouquet Creek Channel

#	Treatment Type	Sample Photo	Material	Ease of Installation	% Privacy Coverage	Pros	Cons	VOTE
1	Flat Tubed Slats		High-Density Polyethylene or Aluminum	Very easy, slides into the top of fence and stays in place without means of attachment.	85%	Inexpensive, Very Durable	Incomplete privacy, Slow installation	
2	Ridged Slats		High-Density Polyethylene or Aluminum	Very easy, slides into the top of fence and stays in place without means of attachment.	85%	Inexpensive, Very Durable, Allows wind to pass through	Incomplete privacy, Slow installation	
3	Privacy Fence Tape Weave		Plastic	Easy, slow installation. Plastic tape has to be woven in and out of each chain link slot	90%	Inexpensive, High privacy cover.	Slow Installation. Plastic material will deteriorate over time.	



# Proposed Design

**Bouquet Canyon Trail Fencing Matrix**

Existing Fencing Along Bouquet Canyon Trail				Proposed Barrier Options Along Bouquet Creek Channel				
#	Barrier Type	Sample Photo	Material	#	Barrier Type	Sample Photo	Material	VOTE
1	Chain Link Fence		Galvanized Steel Wire	1	Valencia Fence		Vinyl	
2	Wood Lodge Pole Fencing		Wood	2	Cable Railing		Stainless Steel	
				3	Chain Link Fence		Galvanized Steel Wire	

